

MODEL:

LIBERTY

BY RIMACOLD A RIMASEE CORP. BRAND

ISLANDS

-9.4°F + -13°F

## Liberty overview doors

Trusted wide island for sales of frozen food . Great vision and capacity for high volume frozen food sales the Sardegna has a wide footprint and deep glazing for the perfect display. The undisputable choice to increase frozen food sales



## Available colours



RIMASEE  
[www.rimasee.com](http://www.rimasee.com)

# MODEL: LIBERTY

# ISLANDS

-9.4°F + -13°F

## Power Supply

Remote

## Climate Class

3 L1

## Food Categories



Frozen  
Food



## Standard features

- Remote cabinet for low temperature
- Panoramic side glass
- Evaporator defrost heater
- Central evaporator with single temperature
- Thermostatic Valve R404 or similar
- With sliding lids
- Modules available in the following lengths: 1875, 2500, 3750 mm.  
And 'HEADCASE' module

## Accessories

- Endwall with glass
- Master electronic control dixell with probes
- Base grids set 3750 (FALSE FLOOR)
- Products grid separator
- Wooden crate to load on 2 levels



RIMASEE  
[www.rimasee.com](http://www.rimasee.com)

CROSS SECTIONS

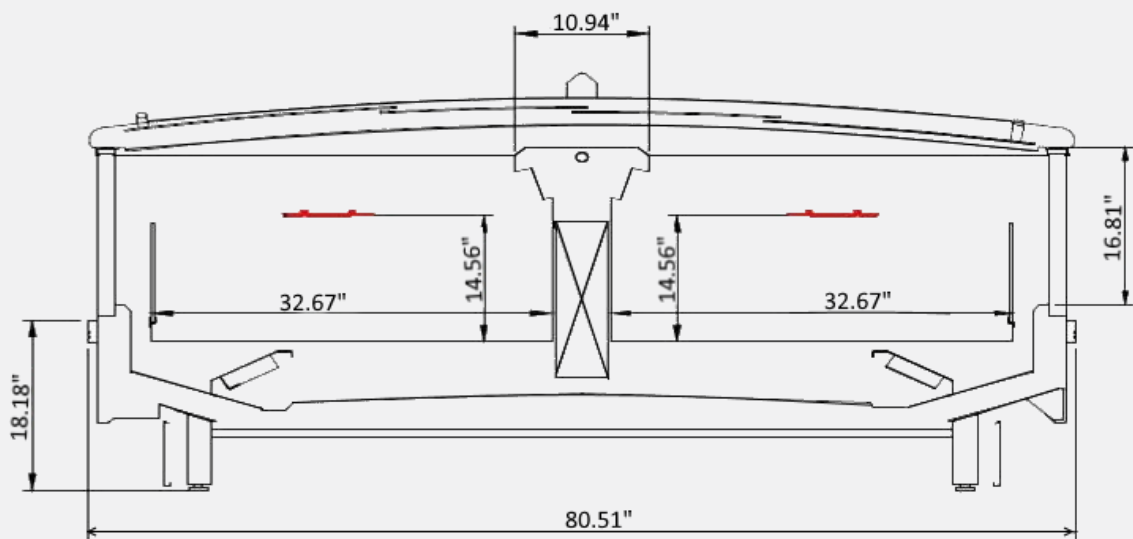
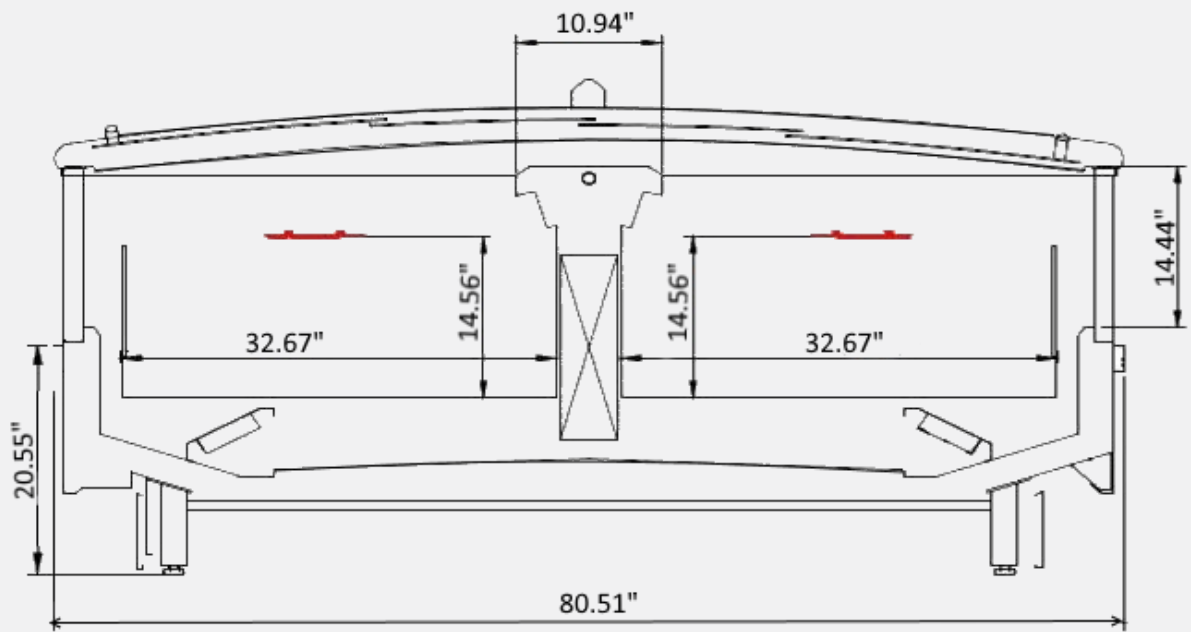

MODEL:  
LIBERTY

ISLANDS

-9.4°F + -13°F

## A SELECTION FROM OUR INSTALLATION



# MODEL: LIBERTY

# ISLANDS

-9.4°F + -13°F

Mod. <b>LIBERTY BT 1E (with closures)</b>		Climatic Class 3 - ta: 77°F / 60% U.R. (UNI EN ISO 23953-2)			
Description	measure unit	<b>BT 1E</b>			
		Product class L1 -0.4°F (-9.4°F + -13°F)			
Lenght without side walls	inches	73.81	98.42	147.63	
Lenght with side walls		80.51	105.11	154.33	
Two side-walls thickness		6.7			
Width		80.11			
Height		35.05			
Load line		14.56			
Depth of load		32.40			
Net weight (without side walls)	lbs	992	1212.54	1653.47	
Net weight side walls		-	-	-	
Display area	ft²	33.26	44.35	66.42	
Refrigerated Volume	dm³	1142	1523	2284	
Evaporator fans	Watt	36	48	72	
Blade	ø / gradient	4715 MS23 TB10 A00			
Defrost	type	Electric with defrost-end thermostat			
Number cycle / 24 h - minimum time	minutes	N° 3 x ca. 25 minutes			
Defrost heater	Watt	2820	3824	5840	
Dripping heater		374	500	750	
Antimist heater escape air		110	148	224	
Antimist heater top frontal window		72	90	124	
Antimist heater bottom frontal window		134	182	276	
Ant. heat. top lateral window (n°1 x side wall)		36	36	36	
Ant. heat. bottom lateral window (n°1 x side wall)	67	67	67		
Supply	Volt/Hz/P	400V 50 Hz (III+N) / 230V 50Hz (III+N)			
Nominal Power¹	Watt	3546	4792	7286	
Electric consuption² (DEC)	kWh/24h	12,44	16,64	24,94	
REC³ (Refrigeration electrical energy consumption)		16,04	21,39	32,08	
TEC (Total energy consumption)		28,48	38,03	57,03	
Heat extraction rate necessary for a multicabinet installation ³	Φ24	Watt	900	1200	1800
				480 W/m	
Average of evaporator temp. θmrun	°F	-30			
Refrigerant	type	R404A			
Thermostatic Valve (Danfoss)	R 404A	TES 2 (or.01)	TES 2 (or.02)	TES 2 (or.03)	
Electronic Valve (Danfoss)	R 404A	AKV 10-2	AKV 10-3	AKV 10-3	

These cases are engineered to operate in locations not exceeding 75°F and 55% R.H. These cases are designed to operate using R404a refrigerant. Alternate refrigerants available by special order. O.A. length includes (2) ends at 1-1/2" each. Ventilation grills at front and back cannot be blocked. B.T.U.'s are calculated at 14°F (evaporator) and 90°F (ambient). Remote cases are provided with an expansion valve and a liquid solenoid for pump down cycle. On remote cases, if no floor drain is provided, a condensate evaporating pan must be ordered and 3.3 amps added to the compressor the amp load. Remote cases must be hard wired – no plugs.

Phone: (347) – 809 3544

Email:

contact@rimacold.com